

 AIR COMFORT

AIR TREATMENT

eCO TOP®

eCO TOP® ENERGY RECOVERY UNIT

» TECHNICAL INSTRUCTION





CONTENT

	Page
Description	3
Components.....	4
Technical data	
Size 25.....	6
Size 40.....	7
Size 55.....	8
Dimensions and weights.....	9
Maintenance space	10
Accessories.....	10
Control functions.....	14
Ordering key.....	16

DESCRIPTION

DESCRIPTION

eCO Top is a top connected unit in three sizes that require minimal space. Compact dimensions and low noise data provides great flexibility in the placement of the unit. All duct connections are on top of the unit. The unit is supplied with energy saving plug fans, supply and extract air filters and a rotating heat exchanger. The Curo control system is integrated with the unit and is ready for use with a large number of functions.

QUALITY & ENVIRONMENT

All units and components from Fläkt Woods are designed, tested and manufactured in accordance with applicable standards including the quality assurance system ISO 9001, the environmental management system ISO 14001.

Substance	Proportion	Recycable	To landfill
Metals	92%	X	
Polymers	2.5%	X	X
Mineral wool insulation	5.0%	X	
Other	0.5%		X

PRODUCT DATA

- Air flow range 100-800 l/s
- High thermal efficiency, up to 85% according to EN308
- Speed controlled rotary heat exchanger
- Built-in Curo control system™
- Built-in post heater (Duct mounted electrical post heater for size 55)
- Simple installation with all connections on top
- Internal silencer (accessory)
- Top and bottom cover available as accessories when unit is placed in public areas
- Attractive design
- Outside of the casing is painted white
- Modbus and Ethernet as standard

TYPICAL INSTALLATIONS

The eCO Top has a wide range of applications and can be installed in most buildings that require ventilation such as schools, offices, conference centers and shops.

When using the accessories internal silencer, top and bottom cover eCO Top can be placed in public areas.



AIRFLOW DIAGRAM

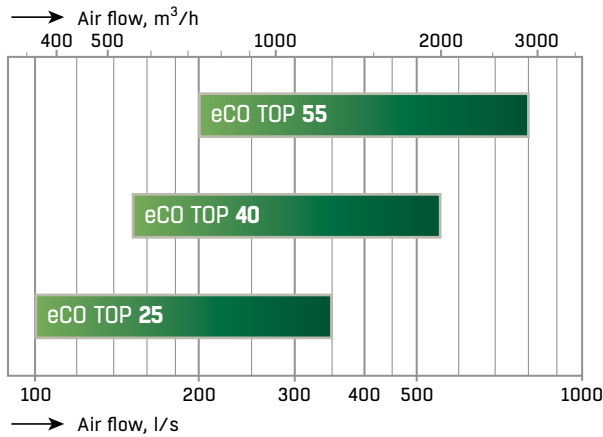

COMPONENTS

COMPONENTS

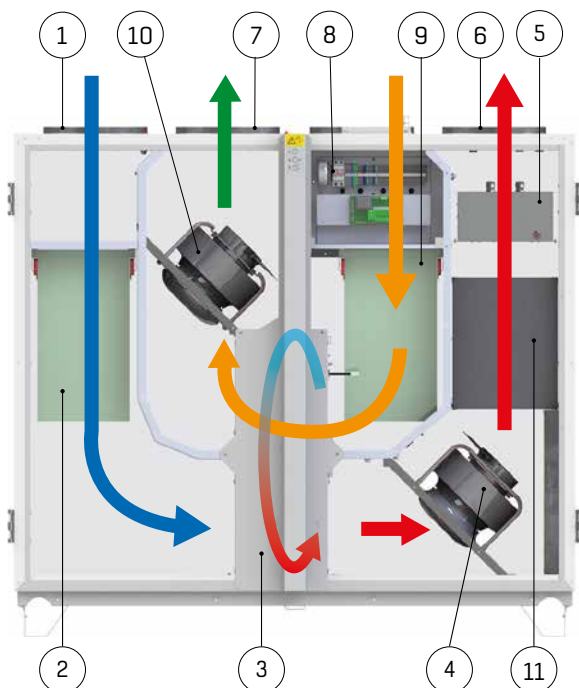

- 1 Outdoor air sensor GT3
- 2 Supply filter
- 3 Rotary heat exchanger with rotation sensor
- 4 Supply fan
- 5 Electrical heater including overheating protection alternatively hot water coil with freeze protection GT5
- 6 Supply air sensor GT1
- 7 Extract air sensor GT12
- 8 Control equipment
- 9 Extract filter
- 10 Exhaust fan
- 11 Internal silencer (accessory)

CASING

The unit is made of galvanized sheet steel and the outside is painted white. The casing is insulated with 50 mm mineral wool. Service hatches for the fans and filter have handles with locks. The unit is supplied on a stable base. Adjustable feet's are available as accessories.

- Corrosivity class C3
- Permeability CEN class L2 (CEN class A)
- Mechanical Strength of casing class D2
- Filter bypass leakage class F7
- Thermal performance of casing (Heat transfer class) corresponding to class T3
- Thermal bridging corresponding to TB3
- Tested according to SS-EN 1886

FILTER



Green Flo bag filter made of PLA for low pressure drop. Filter class F7 on both supply and extract air. The filters are pressed against the sealing strip in the casing.

ROTARY HEAT EXCHANGER



Speed controlled rotor made of non-hygroscopic aluminum provided with a purging sector and rotation sensor. During normal ventilation there is no need for defrosting.

At a relative humidity of the extract air above 30% and an outdoor temperature lower than -15° C there may be a risk of frosting.

COMPONENTS

FAN



eCO Top gives you top performance and overall economy combined with low noise levels. The high efficiency plug fans are powered by energy saving EC motors. The fan speed can be adjusted independently by the unit's Curo control system. Flow, pressure or 3-speed control can be selected.

POST HEATER, HOT WATER

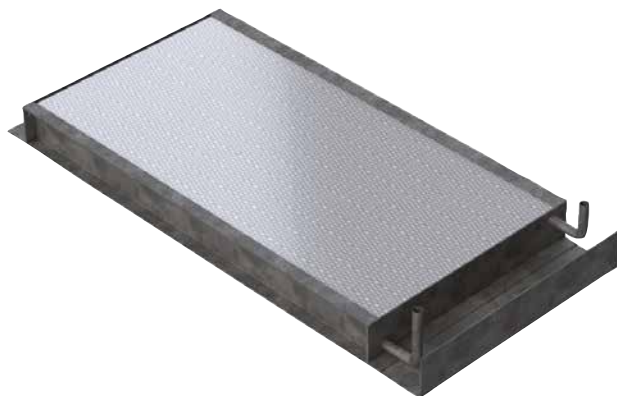

Hot water coil containing copper tubes and aluminum fins. Pipe connection $\varnothing 15$ mm. Freeze protection temperature sensor is included. Max operating pressure 1.0 MPa.

PIPE CONNECTIONS

Size 25 = 3/8"

Size 40 = 12 mm

Size 55 = 12 mm

POST HEATER, ELECTRICAL



The electric heater has built-in control equipment for power control. The element is made of stainless steel. The heater has two thermal overload protection devices, one with an automatic reset and one with a manual reset.

The heater for size 25 and 40 is built-in. For size 55 the heater is duct mounted.

INTERNAL SILENCER (ACCESSORY)



The unit can be ordered with an internal silencer in the supply air which decreases the noise to supply air with approximately 8 dB(A).

The internal silencer also has a positive effect on the noise level to the room.

See selection program Acon for sound calculation.

TECHNICAL DATA – SIZE 25

SUPPLY FAN

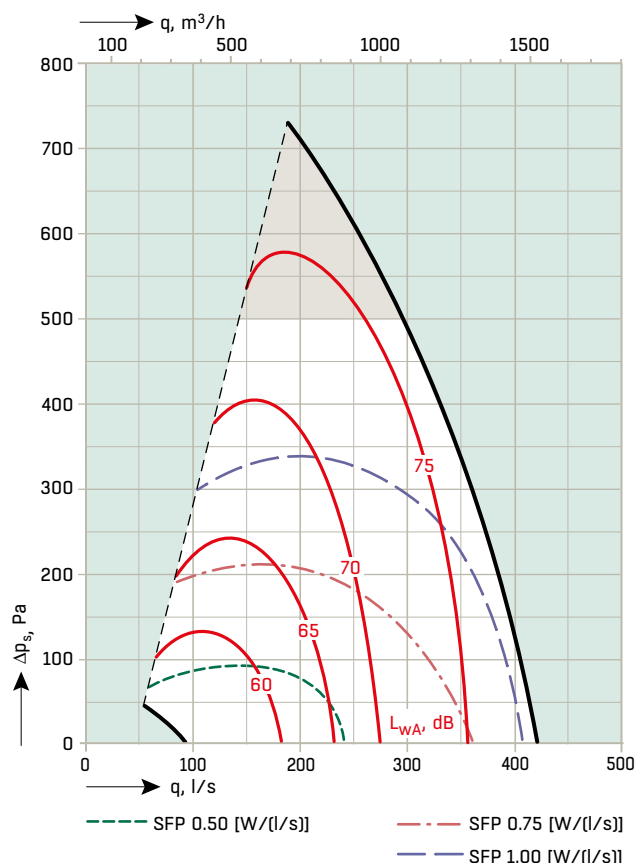

EXHAUST FAN

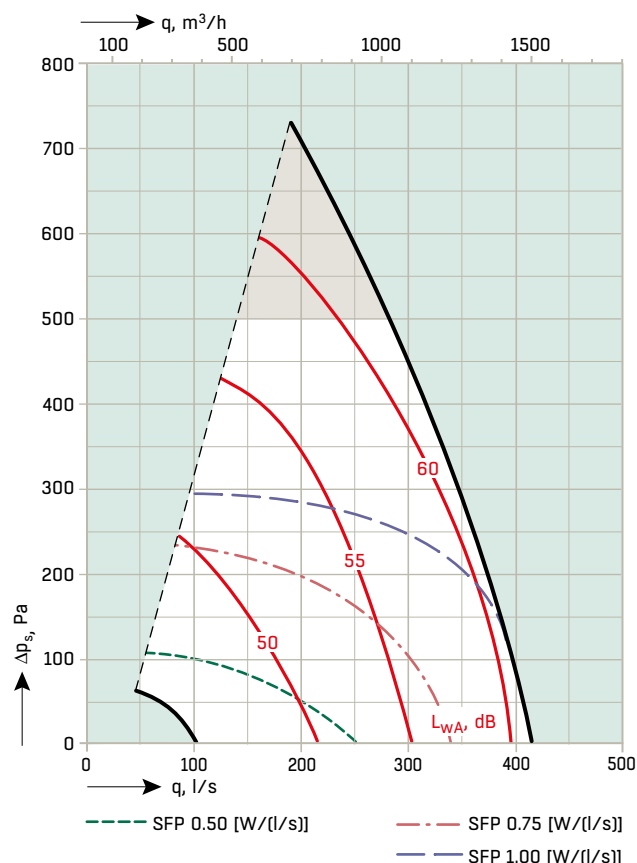

SYSTEM OVERVIEW

The diagrams show the available external pressure drop for the duct system and external components at η_{temp} 80%. Use selection program Acon for calculation. The weighted noise levels given in dB(A) apply to ducts on the fan's outlet side.

The SFP values for each fan are calculated according to the Swedish Association of Air Handling Industries (V document 1995:1 rev. 2000). That means, clean filters, consideration taken to leakage, purging sector airflow and any additional pressure drop for correct pressure balance. Add the SFP values for each fan to get the SFP value for the entire unit.

ELECTRICAL DATA

The mains supply cable must be fitted with an external safety switch, which can cut the current to the entire unit.

Ambient temperature during operation 0 - 40° C

Unit with	Hot water coil	Electrical coil
Supply	1 x 230 V	3 x 400 V
Fuse	10 A	10 A

Motor data	0.385 kW x 2	2.5 A x 2	1 x 230 V
Electrical heater	4 kW	10 A	2 x 400 V

TEMPERATURE EFFICIENCY

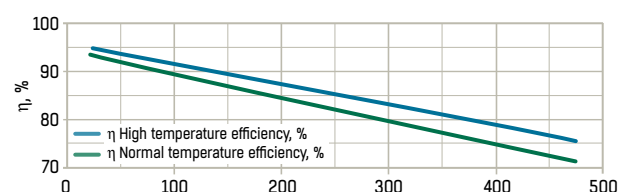

FILTER

Bag filters, class F7 in supply and extract air.

TECHNICAL DATA – SIZE 40

SUPPLY FAN

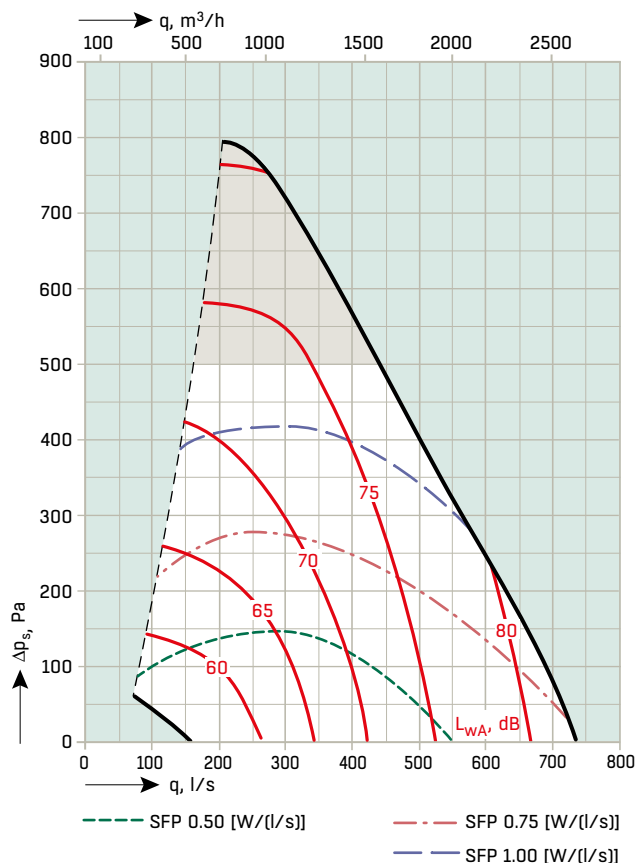

EXHAUST FAN

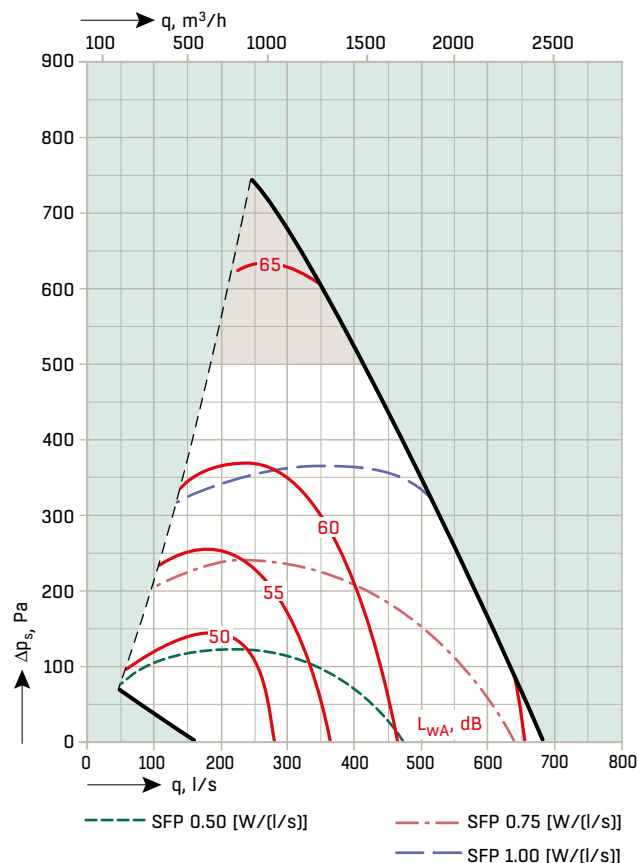

SYSTEM OVERVIEW

The diagrams show the available external pressure drop for the duct system and external components at η_{temp} 80%. Use selection program Acon for calculation. The weighted noise levels given in dB(A) apply to ducts on the fan's outlet side.

The SFP values for each fan are calculated according to the Swedish Association of Air Handling Industries (V document 1995:1 rev. 2000). That means, clean filters, consideration taken to leakage, purging sector airflow and any additional pressure drop for correct pressure balance. Add the SFP values for each fan to get the SFP value for the entire unit.

ELECTRICAL DATA

The mains supply cable must be fitted with an external safety switch, which can cut the current to the entire unit.

Ambient temperature during operation 0 - 40° C

Unit with	Hot water coil	Electrical coil
Supply	1 x 230 V	3 x 400 V
Fuse	10 A	16 A

Motor data	0.5 kW x 2	2.2 A x 2	1 x 230 V
Electrical heater	6 kW	15 A	2 x 400 V

TEMPERATURE EFFICIENCY

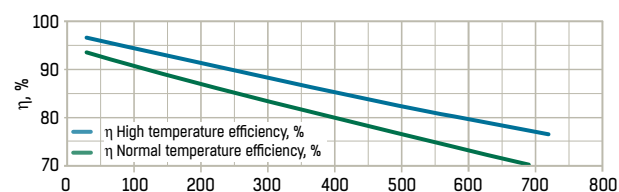

FILTER

Bag filters, class F7 in supply and extract air.

TECHNICAL DATA – SIZE 55

SUPPLY FAN

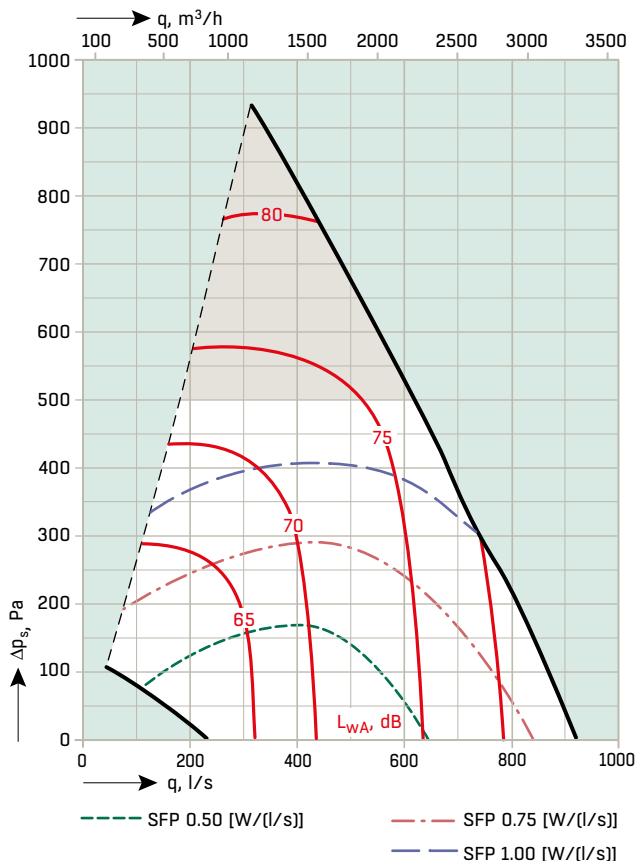

EXHAUST FAN

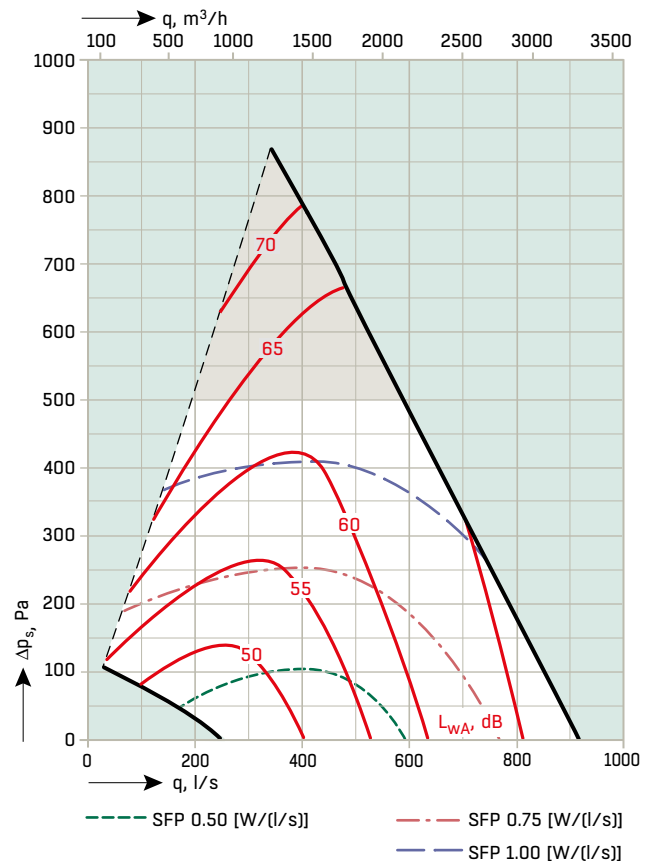

SYSTEM OVERVIEW

The diagrams show the available external pressure drop for the duct system and external components at η_{temp} 80%. Use selection program Acon for calculation. The weighted noise levels given in dB(A) apply to ducts on the fan's outlet side.

The SFP values for each fan are calculated according to the Swedish Association of Air Handling Industries (V document 1995:1 rev. 2000). That means, clean filters, consideration taken to leakage, purging sector airflow and any additional pressure drop for correct pressure balance. Add the SFP values for each fan to get the SFP value for the entire unit.

ELECTRICAL DATA

The mains supply cable must be fitted with an external safety switch, which can cut the current to the entire unit.

Ambient temperature during operation 0 - 40° C

Unit with	Hot water coil	Electrical coil
Supply	1 x 230 V	1 x 230 V
Fuse	10 A	10 A

Motor data	0.75 kW x 2	3.3 A x 2	1 x 230 V
Electrical heater ¹⁾	9 kW	13 A	3 x 400 V

¹⁾ Electrical heater has a separate supply.

TEMPERATURE EFFICIENCY

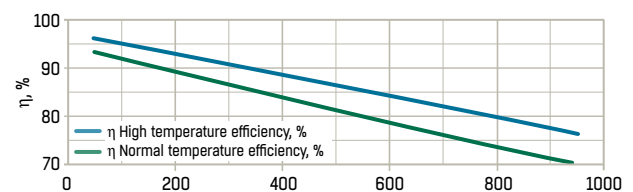

FILTER

Bag filters, class F7 in supply and extract air.

DIMENSIONS AND WEIGHT



Detailed pictures show the location of the pipe transit for hot water coil.

Size	B	D	H	a	b	c	d	e	f	g	h1	W
25	1570	678	1210	220	360	217	Ø250	410	393	800	139	260
40	1720	778	1400	250	405	247	Ø315	410	463	900	139	300
55	1990	888	1400	71	216	85	600	300	–	1000 ¹⁾	139	400

All dimensions in mm, W = weight in kg

¹⁾ To move size 55 through a 900 mm opening, remove the doors and the central strut.

CONNECTIONS SIZE 25 AND 40, LEFT HAND VERSION

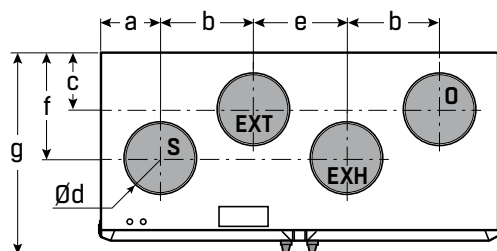

CONNECTIONS SIZE 25 AND 40, RIGHT HAND VERSION

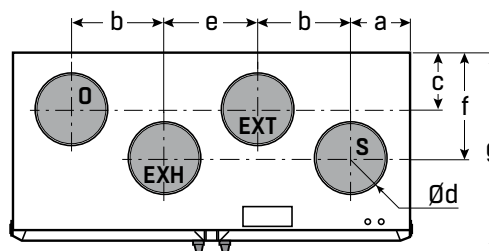

CONNECTIONS SIZE 55, LEFT HAND VERSION

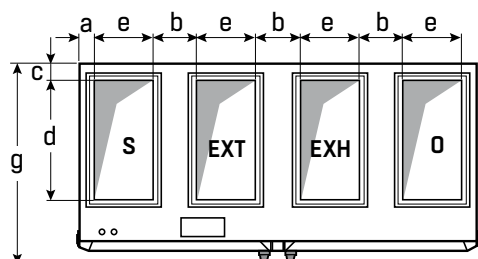

CONNECTIONS SIZE 55, RIGHT HAND VERSION

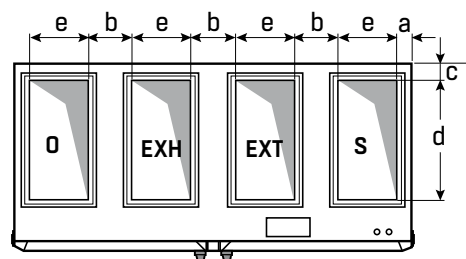

S = supply air

O = Outdoor air

EXT = Extract air

EXH = Exhaust air

MAINTENANCE SPACE, ACCESSORIES

MAINTENANCE SPACE

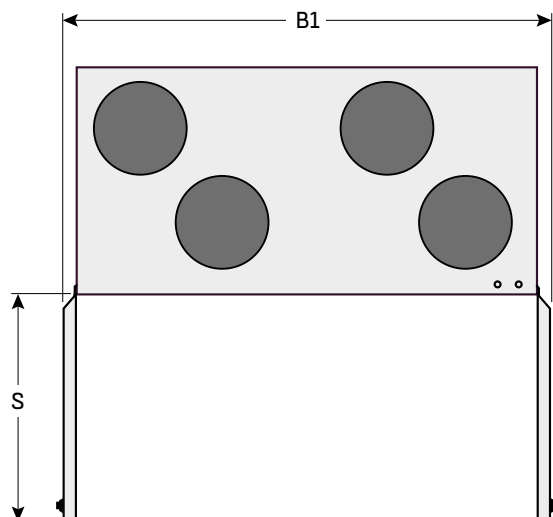

Size	B1	S
25	1690	760
40	1840	840
55	2110	970

B1 = width with open doors

S = minimum service space

in front of the control cabinet there has to be enough space according to local electrical regulations.

ACCESSORIES, GENERAL

All accessories have rectangular PG connection.

Adapter PG / flange available as accessories. Four adapters for duct connection are included the size 55.

DUCT MOUNTED COOLING COIL - RDTZ-14



Cold water coil containing copper tubes and aluminum fins. The coil is built-in to a galvanized sheet steel casing. The casing has a removable hatch for cleaning and duct connections with rubber ring seals. The cooler has to be installed horizontally and the distance to nearest bend has to be at least 600 mm. The cooler is only available in a left-hand version.

Venting and draining is carried out via the pipe system. The pipe connection, Ø 22 mm, is located on the outlet end, is smooth and is intended for a compression fitting. The drainage tray is in stainless steel and has an R 1/2" connection.

Maximum operating pressure 1.0 MPa and maximum operating temperature 150° C.

SHUT OFF DAMPER WITH ACTUATOR - RDTZ-87



Duct mounted damper in leakage class 3 (CEN 3). The damper is made of galvanized sheet steel and has a spring return on/off actuator. The actuator has to be connected to a terminal block in the electrical cabinet.

The damper has duct connections with rubber ring seals and can be mounted directly onto the unit or in the duct system. It is designed for duct insulation of up to 50 mm.

At air speeds below 10 m/s and the damper fully open the sound power level is below 20 dB.

A shut-off damper with spring return actuator shall be used for units with water coil.

SILENCER, CIRCULAR – RDTZ-16



The silencer is a straight circular duct silencer with 50 mm mineral wool filling. Duct connections have rubber seals. The silencer consists of a perforated sheet metal pipe surrounded by a galvanized sheet steel mantle and end pieces sandwiching mineral wool covered with nonwoven fabric to prevent fiber migration.

Fire resistance rating EI30.

The distance to the fan has to be at least 300 mm.

ACCESSORIES

RECTANGULAR SILENCER, DUCT MOUNTED – RDTZ-15

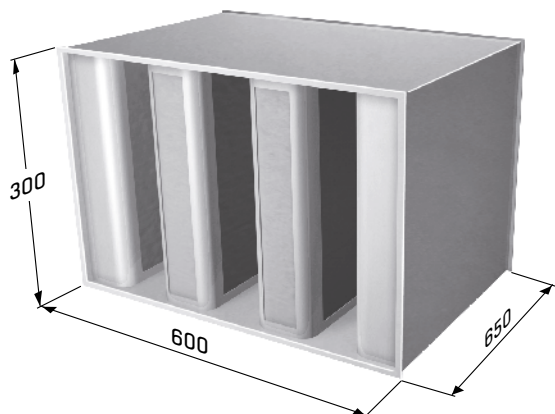

The silencer is intended to be connected to a rectangular duct or directly to the unit. The casing has no isolation. The sound baffles are covered with glass fabric for dry cleaning.

The silencer has a casing of galvanized sheet steel with baffles with rounded fronts. The gap between the baffles narrows in the direction of the air flow to get the lowest possible pressure drop.

The baffles have a filling of mineral wool for attenuation.

The silencer fulfills leakage class C if the duct connections are correctly performed.

MOUNTING FEET – RDTZ-13



The height of the mounting feet can be adjusted between 55 - 120 mm. The unit can be placed directly onto the surface if this is flat and horizontal.

SPARE FILTER – RDTZ-81



Bag filters for supply and extract air. Filter Class F7.

FLEXIBLE CONNECTION – RDTZ-55

Flexible connection in fiber glass for connection of ducts.

MANOMETER, AIR FLOW – RDTZ-56

Manometer for air flow measurement. Cannot be used together with Constant Air Volume control.

MANOMETER, FILTER – RDTZ-07



Manometer for measuring filter pressure drop.

DRAIN TRAP - RDTZ-08

Compact drain trap for duct mounted cooling coil.

ACCESSORIES

TOP COVER – RDTZ-20



The cover has the same white color as the unit and is used to hide the duct work. The cover is delivered unmounted. It is intended for ceiling heights, 2400 mm.

BOTTOM COVER – RDTZ-21



The cover has the same white color as the unit and is delivered unmounted. It is intended for units without mounting feet.

CONVERTER FROM RECTANGULAR TO CIRCULAR – RDTZ-24



For unit size 55.

CONVERTER FROM PG TO FLANGE – RDTZ-25



4 pcs included for size 55.

ACCESSORIES

COMBINATION COVER – RDTZ-59-25



Cover for outdoor air and exhaust air, intended for wall mounting. The cover prevents mixing of the two air flows. It is made of plastic coated sheet metal.

DIMENSIONS - RDTZ-59-25

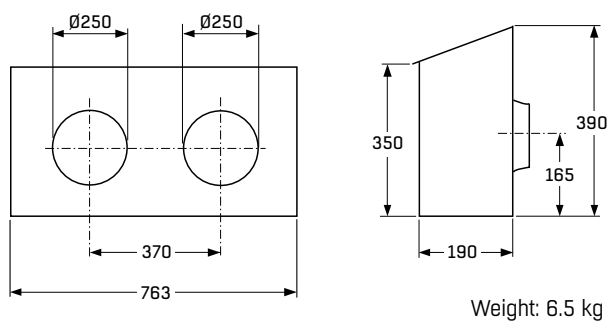

COMBINATION COVER – RDTZ-59-40



Cover for outdoor air and exhaust air, intended for wall mounting. The cover prevents mixing of the two air flows. It is made of plastic coated sheet metal.

DIMENSIONS - RDTZ-59-40

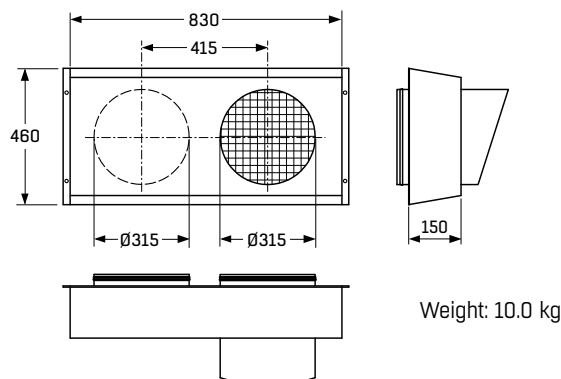

PRESSURE DROP - RDTZ-59-25

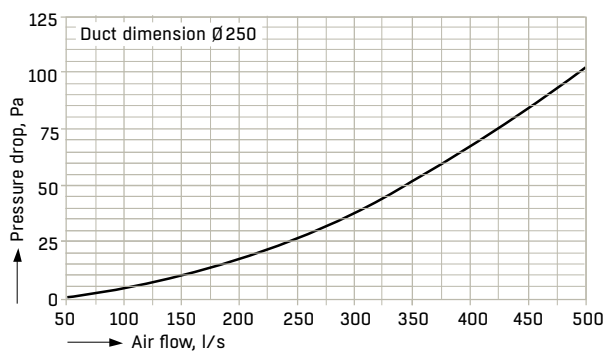

PRESSURE DROP - RDTZ-59-40

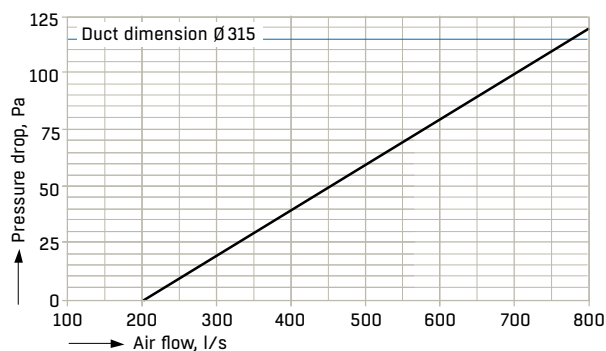

CONTROL FUNCTIONS

GENERAL

eCO Top is supplied with integrated control platform Curo including the Curo Touch control panel.

The Curo platform has been developed to be easy to use. All internal components are pre-connected and the unit is factory tested.

The control system can communicate via Modbus RS485 or Modbus TCP/IP.

Functions that are ordered together with the unit are activated and configured from factory. Some functions are possible to activate on site.



STANDARD FUNCTIONS

- Supply air control
- Fan control (3 speed)
- Stepless speed control of RHE
- Cooling recovery
- Frost protection sensor; units with hot water coil
- Schedules
- Control circuit for pumps, max 2A
- Inlet for external fire alarm

FUNCTIONS THAT CAN BE ACTIVATED ON SITE

- Extract air control
- Outdoor air temperature compensation
- Night cooling

ACCESSORIES

- Defrosting
- Filter monitor
- Room control
- Extended / forced operation through external timer or PIR
- COP, CAV or CO₂ control

FAN SPEED CONTROL

The fans in the eCO Top have three different speeds: Low, Normal and High. Switching fan speed is carried out using schedules, an external timer, push button or PIR, flow, pressure or CO₂ control is available as accessories.

TEMPERATURE CONTROL

Following options are available:

Supply air control

Maintain the supply air temperature.

Extract air control

Maintain the extract air temperature through cascade control of the supply air temperature with minimum and maximum limitation.

Room control (accessory)

Maintain the room temperature through cascade control of the supply air temperature with minimum and maximum limitation.

OUTDOOR TEMPERATURE COMPENSATION

The supply air temperature set point is changing depending on the outdoor air temperature. Not in combination with extract air or room control.

NIGHT COOLING

Night cooling is used during warm summer nights in order to reduce the indoor temperature. This is provided by cooling the warm indoor air with cold outdoor air.

When both the room temperature and outdoor temperature exceeds the set threshold value, and the difference between these values exceeds the difference set point, the unit is started in order to cool the building.

COOLING RECOVERY

The rotary heat exchanger will start to cool the supply air when the extract air temperature is lower than the outdoor air temperature and there is a cooling demand.

CONTROL OF POST HEATER

Control signal 0-10 V for valve actuator or electrical heater with a built-in thyristor.

FREEZE PROTECTION

The valve is controlled to keep the water return temperature above 15°C. If the temperature drops below 7°C the unit is stopped and an alarm is generated. When the unit is not in operation the water temperature is maintained at 25°C.



CONTROL FUNCTIONS

CIRCULATION PUMPS

The control system can start and stop circulation pumps for heating and cooling. The pumps start up every 24 h for a test run. The maximum current for both pumps is 2A.

CONTROL OF COOLING COIL

Control signal 0-10 V for valve actuator or a start signal for a cooler with direct expansion, DX.

FIRE PROTECTION

A separate fire protection system can be connected to the unit. Functions available are Stop the unit or Fans running.

COMMUNICATION

The control system can communicate via Modbus RS485 or Modbus TCP/IP.

FILTER MONITOR RDTZ-28 (ACCESSORY)

Generates an alarm if the pressure drop over the filter exceeds the set point.

DEFROSTING RDTZ-80 (ACCESSORY)

A pressure monitor is used to determine if defrosting is necessary.

EXTENDED/FORCED OPERATION, EXTERNAL TIMER RDTZ-91-1 (ACCESSORY)

External timer, 0-5 hours.

EXTENDED/FORCED OPERATION, PIR RDTZ-92-1 (ACCESSORY)

Delivered separately for mounting on site.

SAFETY SWITCH RDTZ-89

Delivered separately for mounting in connection to the unit.

VALVE/ACTUATOR FOR HEATING/COOLING COIL RDTZ-70

Delivered separately for mounting on site.



ORDERING KEY

Energy recovery unit eCO Top

RDTP-aa-b-c-d-e-ff

Size (aa) _____
25, 40, 55

Supply side and efficiency (b) _____
1 = Right, Standard efficiency, RHE = 80%
2 = Left Standard efficiency, RHE = 80%
3 = Right, High efficiency, RHE = 85%
4 = Left, High efficiency, RHE = 85%

Fan speed control (c) _____
1 = Standard, 3-speed
2 = COP, Constant Pressure, Supply/exhaust
3 = CAV Constant air volume, Supply/exhaust
4 = CO₂ control (internal sensor)

Post heater options (d) _____
0 = Without
1 = Electrical (duct mounted for size 55)
2 = Hot water

Filter Supply / Exhaust (e) _____
1 = F7 bag filter

Language (ff) _____
01 = Swedish
03 = English
04 = Finnish
07 = French

ACCESSORIES

Adjustable mounting feet, kit

RDTP-13-1

Drain trap

RDTP-08-1

Temperature control

RDTP-61-b-c

Control situation (b) _____
2 = Extract air control
3 = Room air control (room sensor delivered separately)
4 = Supply air control with outdoor air compensation

Generation (c) _____
1

Defrosting

RDTP-80-b-c

Type (b) _____
1 = Pressure sensor

Generation (c) _____
1

Circular duct mounted cooling coil

RDTP-14-bb-c-d

Size (bb) _____
25, 40, 55

Type (c) _____
1 = Water

Connection side (d) _____
2 = Left

Filter monitor

RDTP-28-b-1

Type (b) _____
1 = Filter monitor, supply/exhaust

Safety switch

RDTP-89-bbb-1

Delivered separately

Current (bbb) _____
016 = 16 A

Extended/forced operation, external timer

RDTP-91-1

Extended/forced operation, PIR

RDTP-92-1

Valve/actuator for heating/cooling coil

RDTP-70-b-c-d-eee

Scope of supply (b) _____
1 = Actuator only
2 = Valve with actuator
3 = Valve only

Type of valve (c) _____
0 = Without (b = 1)
2 = 2-way
3 = 3-way

Location (d) _____
1 = Värme
2 = Kyla

kvs-value (eee) _____
002 = 0.25 010 = 1.0
004 = 0.40 016 = 1.6
006 = 0.63 025 = 2.5



ORDERING KEY

Spare filter

RDZ-81-bb-c

Size (bb) _____

25, 40, 55

Type (c) _____

1 = F7 (2 pcs)

Manometer, fan pressure

RDZ-56-1

Manometer, U-pipe for filters

RDZ-07-1

Combination cover

RDZ-59-bb

Size (bb) _____

25 = Size 25

40 = Size 40

Silencer, Rectangular

RDZ-15-bb-c

600x300 mm, L = 650 mm

Size (bb) _____

55 = Size 55

Type (c) _____

1 = PG

Silencer, Circular

RDZ-16-bb-ccc

Size (bb) _____

25 = Size 25, Ø250 mm

40 = Size 40, Ø315 mm

Length (ccc) _____

060 = 600 mm

090 = 900 mm

Shut off damper with actuator

RDZ-87-bb-c-d

Size (bb) _____

25 = Size 25, Ø250 mm

40 = Size 40, Ø315 mm

55 = Size 55, 600 x 300 mm

Type (c) _____

0 = For sizes 25 and 40

1 = PG, unisolated blades, size 55

3 = PG, isolated blades, size 55

Actuator (d) _____

2 = On-off, spring return

HMI extra cabel

RDZ-76-bb

Length (bb) _____

10 = 10 meters

25 = 25 meters

Internal silencer

RDZ-19-bb

Size (bb) _____

25, 40, 55

Flexible connection

RDZ-55-bb-c

Size (bb) _____

25 = Size 25, circular

40 = Size 40, circular

55 = Size 55, rectangular

Type (c) _____

0 = For sizes 25 and 40

1 = PG, size 55

Top cover

RDZ-20-bb-1

Bottom cover

RDZ-21-bb-1

Size (bb) _____

25, 40, 55

Converter from rectangular to circular

RDZ-24-bb-c

Size (bb) _____

55 = size 55 (from 600 x 300 mm to Ø400 mm)

Type (c) _____

1 = PG

Converter from PG to flange

RDZ-25-bb-c

Size (bb) _____

55 = Size 55

Type (c) _____

1 = PG/flange

WE BRING **BETTER AIR**TM TO LIFE

With over a century of innovation and expertise to share with our customers, Fläkt Woods is a global leader in Air Technology products and solutions. We specialize in the design and manufacturing of a wide range of products and solutions for Air Movement, Air Treatment, Air Distribution, Air Management and Air Diffusion with focus on two major benefits – **Air Comfort** and **Fire Safety**. With market presence in 65 countries we are in a unique position to be a local supplier and an international partner in our customer's projects.

Our product brands such as SEMCO®, eQ®, eQ Prime®, JM Aerofoil®, Econet®, Veloduct®, Optivent®, Optimix®, Econovent® and Cleanvent® are well-known and trusted by customers all over the world to deliver high quality and energy efficient solutions.

» To learn more about our offering and get in contact with your nearest sales representative please visit www.flaktwoods.com

WWW.FLAKTWOODS.COM

eCO TOP® | 9823GB | 20160705